

# Love Notes & Imagine – Card Set



– Love Notes & Imagine Card Set –

Designed by ~ Carla La Vera

## Graphic 45® Supplies:

- 1 ea *Love Notes* 8x8 Collector's Pack w/ Stickers (4502781)
- 1 ea *Imagine* 8x8 Collector's Pack w/ Stickers (4502723)
- 1 pk A2 Cards 4¼" x 5½" & Envelopes—Ivory (4502652)

## Additional Supplies, Tools, Adhesives & Ink:

Paper trimmer, detail scissors, scoring tools, bone folder, ruler, adhesive, craft knife, pencil, Optional: brown ink

## Notes:

- Measurements are width x height unless specified.
- We are going to work with two collections! This tutorial will show you how to do two cards with *Imagine* and one card with *Love Notes* collector editions which feature the new 8x8 sticker sheets! These cards are fun and easy, so you can create many others using the remaining supplies in your kit, by following the same steps using other papers!

## Directions:

~ Score and fold the 8½" x 5½" cardstock down middle to create 4¼" x 5½" cards.



~ Cut three 5½" x 2" pieces of *Create Yourself* (b-side), *Adventure Beckons* (b-side) and *Melodic Missives* (b-side), trim the lateral edges according to the lateral edges of the flaps and add them to the flaps. Add a stamp to the upper right corner of the front section of the envelopes.

~ Card No. 1

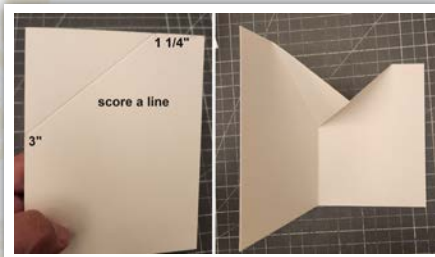

1. Take one card and place it vertically in front of you, make a mark on the upper edge at 1¼" from the right edge and make

another mark on the left edge at 3" from the bottom edge. Score a line between these marks in both sections of the card then, fold the triangle sections inside the card as shown in the image.

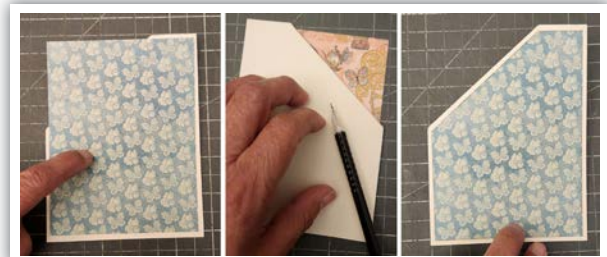

2. Cut a 4" x 5¼" piece of *Create Yourself* (b-side), place it over the card keeping the face side up, center it between the lateral edges and line it up with the upper edge, flip it over and make a mark on the diagonal edge and trim this piece leaving ⅛" from the mark then, add it to the card.

# Love Notes & Imagine – Card Set



3. Cut two 4" x 5 1/4" pieces of *Futuristic Fantasy*, place one piece over the card keeping the face side down, center it between the lateral edges and line it up

with the upper edge, flip it over and make a mark on the diagonal edge and trim this piece leaving 1/8" from the mark.

4. Trim the second piece, using the trimmed piece as a template, place it against the second piece (face to face) and trim the corner. Open the card and add the *Futuristic Fantasy* pieces.

5. Trim two triangles using *Create Yourself* (b-side)



as shown and add to the folded triangles of the card.



6. Unfold the triangle section of the card, trim and score a line as shown and fold

the triangle again and keep the rectangle section folded in the opposite direction.

7. Fussy cut the elements shown from *Up and Away* and add them to the front of the card, trim 4" of the borders (stickers pink and blue) and add them to the bottom section, finally, add the sticker shown.



8. Fussy cut the elements shown from *Up and Away* and add them to the triangles. Add the small Air balloon to the rectangle behind the triangles.

9. Trim the border shown (*Adventure Beckons*), split it in two 4" pieces and add it to the bottom section of the card, then add the card "Time is Flying" from *Castles in the Air*.



~ Card No.2

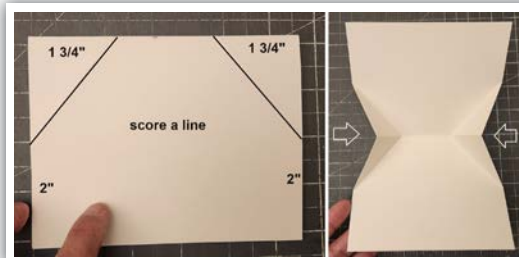

1. Take one card and place it horizontally in front of you,

make a mark on the upper edge at 1 3/4" from the left and right edges and make other marks on the left and right edges at 2" from the bottom edge, score a line between the marks as shown and fold the triangles inside the card.

2. Cut a 5 1/4" x 4" piece of *Imagine* paper (center the word "Imagine" when you trim the piece), place it over the card keeping the face side up,



# Love Notes & Imagine – Card Set

center it between the lateral edges and line it up with the upper edge, flip it over and make a mark on both diagonal edge and trim these pieces leaving  $\frac{1}{8}$ " from the mark then, add it to the card. Add the "Dreamer" sticker to the card.

3. Cut two 4" x 5 $\frac{1}{4}$ " pieces of *Spread your Wings*, place one piece over the card keeping the face side down and mark and cut the triangles as we did in step 2.

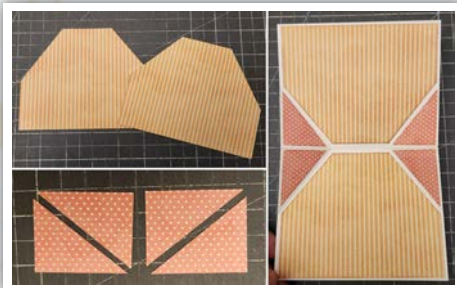

4. To trim the second piece, use the trimmed piece as a template, place it against the second piece (face to face) and trim the corner. Open the card and add both pieces as shown.

5. Trim two rectangles (1 $\frac{1}{2}$ " x 1 $\frac{7}{8}$ ") using *Castles in the Air* (b-side) then, trim these rectangles as shown and add them to the folded triangles of the card.

6. Add the banner (stickers) to the upper left corner of the card. Trim 5 $\frac{1}{4}$ " of the border shown (*Adventure Beckons*) and add it to the bottom section of the card, then, add the card "Build Castles in the Air" (*Castles in the Air*).



7. Fussy cut the element shown from *Create Yourself* and add them to the triangles inside the card.

~ Card No. 3

1. Take one card and place it vertically in front of you, make a mark on the upper edge at 1 $\frac{1}{4}$ " from the right edge and make another mark on the left edge at 3" from the bottom edge. Score a line between these marks in both sections of the card then, fold the triangle sections inside the card as shown in the image for the first step for Card 1..

2. Cut a 4" x 5 $\frac{1}{4}$ " pieces of *Standing Ovation*, place it over the card keeping the face side up, center it between the lateral edges

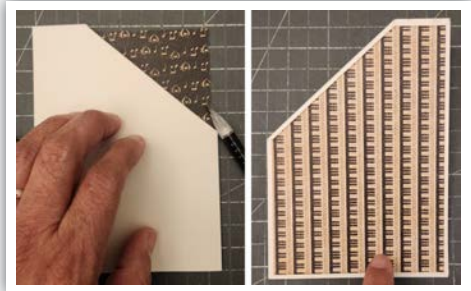

and line it up with the upper edge, flip it over and make a mark on the diagonal edge and trim this piece leaving  $\frac{1}{8}$ " from the mark then, add it to the card.

3. Cut two 4" x 5 $\frac{1}{4}$ " pieces of *Romantic Rhapsody* (b-side), place one piece over the card keeping the face side down, center it between the lateral edges and line it up with the upper edge, flip it over and make a mark on the diagonal edge and trim this piece leaving  $\frac{1}{8}$ " from the mark.



4. To trim the second piece, use the trimmed piece as a template, place it against the second piece (face to face) and trim the corner.



Open the card and add the *Romantic Rhapsody* pieces.

5. Trim two triangles using *Melodic Missives* (b-side) as shown and add them to the folded triangles of the card.

6. Unfold the triangle section of the card, trim and score a line as shown and fold the triangle again and keep the rectangle section folded in the opposite direction.



# Love Notes & Imagine – Card Set



7. Add the cards shown (*Lovely Lyrics*) to the front of the card. Add the Sticker shown to a piece of dark paper (use leftovers), trim it around leaving a thin border then, add it to the front of the card.

8. Fussy cut two roses from *Floral Symphony* and add them to the triangles. Fussy cut the card

shown (*Poetic Postage*) and add it to the triangle. Add a small stamp to the rectangle section.

9. Trim two pieces (4”) of the border shown (*Poetic Postage*) and add it to the bottom

section of the card, then, add a card of *Poetic Postage*.



You can complete a variety of additional cards, by following the same steps, using other paper from the collection!

- Find more information on the Graphic 45 YouTube Channel •

